

012 Bookshelf Installation Steps

Bookshelf



5*14 single line self tapping screw



5*30 self-tapping screws

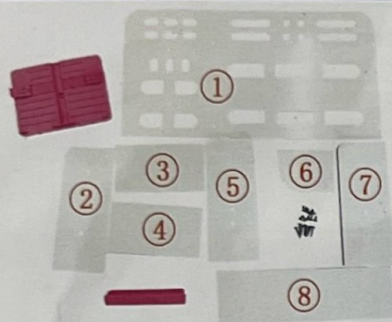

1. Take out the bookshelf and check whether the accessories are complete

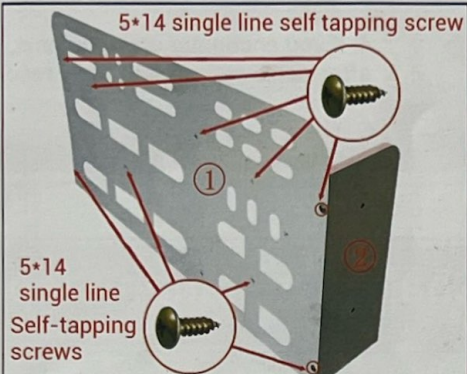

2. Fix plate 1 and plate 2 with screws

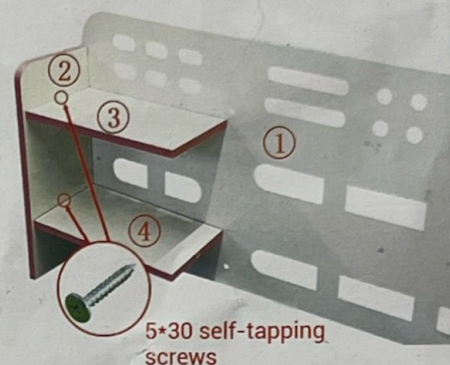

3. Connect boards 3 and 4 to boards 1 and 2 in sequence

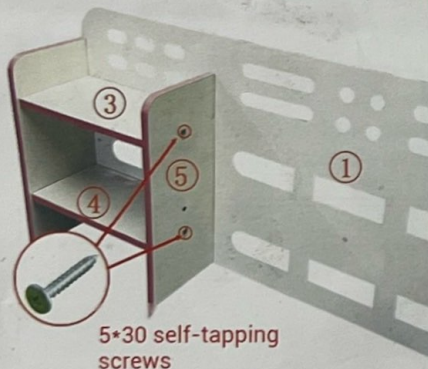

4. Connect board 5 to board 1, board 3, and board 4 in sequence



5. Connect board 8 to board 1 and board 5 in sequence

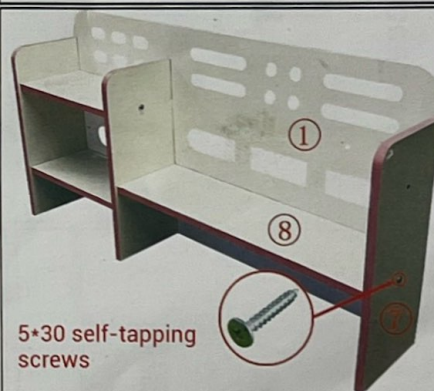

6. Connect board 7 to board 1 and board 8 in sequence



7. Connect board 6 to board 1 and board 7 in sequence



8. Use 5*30 for the bookshelf and desktop respectively. Self-tapping screw link



9. Install the book holder on the desktop as shown in the picture. The desktop installation is complete.

Important!!! Be sure to distinguish the accessories before installation! To facilitate installation!

SQ

Install after-sales service card

(Please keep it properly)

Note: Only adults are allowed to install, keep children away

1. Install the program strictly according to (Attached photo: Installation diagram) Steps
2. Pay attention to protection during installation and do not damage the surface of the components
3. After each connector is installed, tighten it
4. If you encounter any problems, please contact after-sales service for timely resolution
5. The product is suitable for people aged 3-18



SQ-012 Chair Installation Steps

Chair accessories



5*25 gold self-tapping screws



6*10 hexagon socket screw



6*8 Phillips screws



6*16 hexagon socket screws

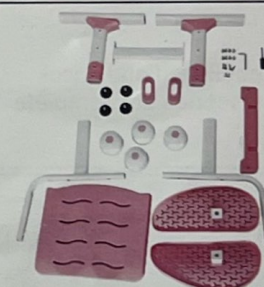

1. Take out the chair parts for installation

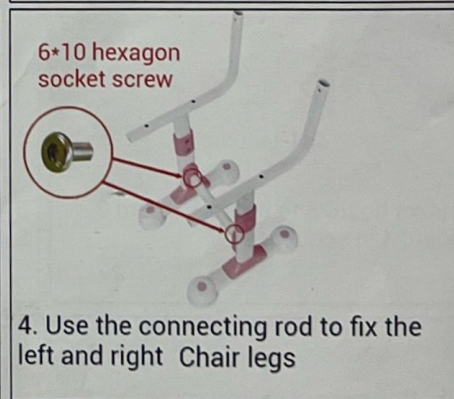
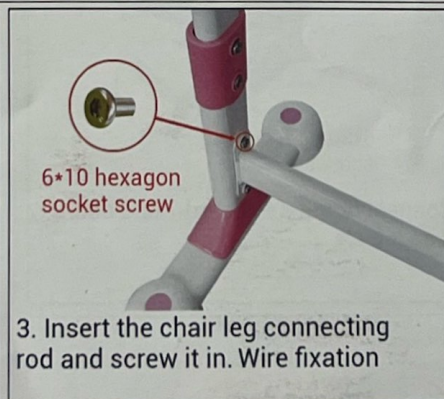

Special attention! Only adults are allowed to install, keep children away! To prevent collision or accidental swallowing of hardware!

012 Table Installation Steps

Table accessories



Notice

After installation, if the table and chairs
The base is not level. You need to adjust
the leveling feet. Loosen up a bit.
Use 10-15 days to tighten
One screw can extend the length of the
table and chair Service life

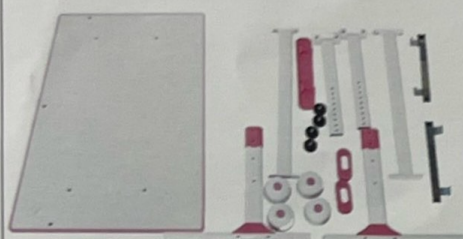

1. Take out the parts for installing the table



2. Pull out the telescopic table legs to adjust the height to suit you and fix them with screws

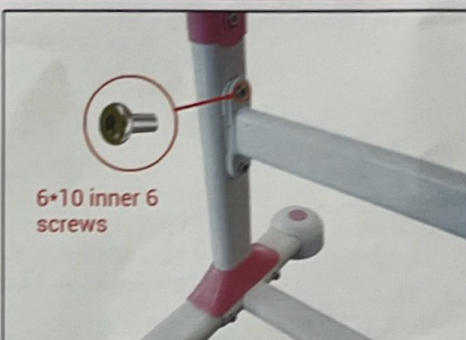

3. Insert the table leg connecting rod and screw it in. Wire fixation

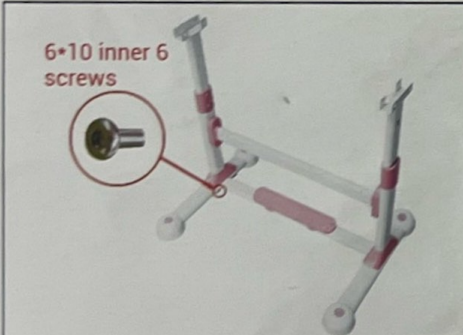

4. Use the connecting rod to fix the left and right table legs and fix them with screws.

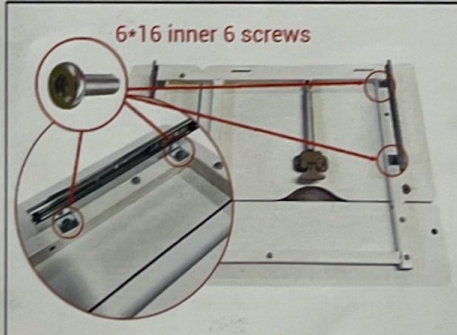

5. Align the slide rail with the hole and fix it to the desktop with screws.

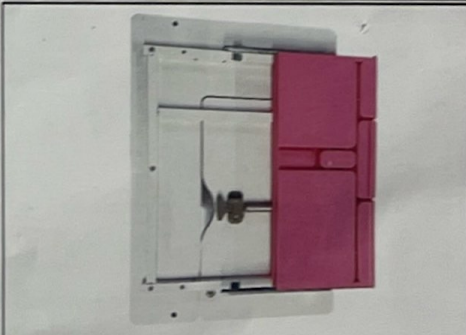

6. Install the drawer into the slide rail



7. Place the table legs upside down on the tabletop and align them with the holes.



8. Fix the left and right legs to the table top with screws



9. Install the bookshelf and table